

USER + INSTALLATION

> Instructions

Thule VeloSwing
Ducato/Jumper/Boxer > 2007
Movano > 2022

302064

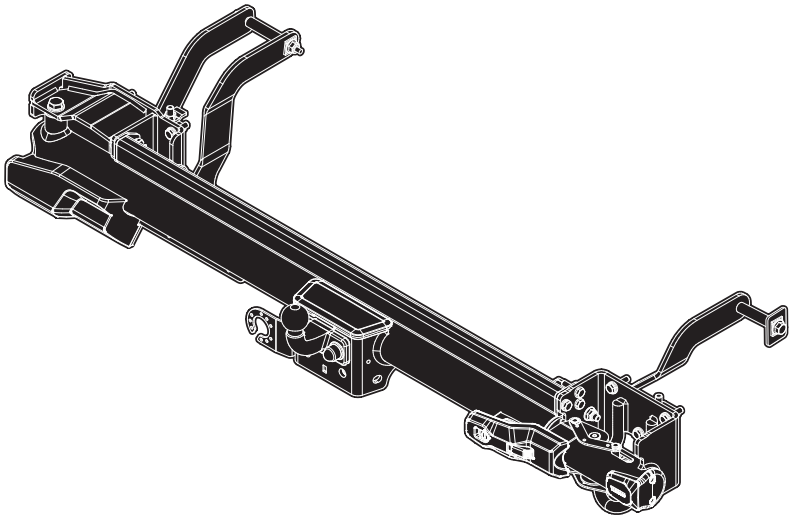

DECLARATION OF CORRECT INSTALLATION

COSTRUTTORE	MANUFACTURER	GDW N.V.
RIFERIMENTO	REFERENCE	-
AUTOVEICOLO	VEHICLE	Fiat Ducato / Citroën Jumper / Peugeot Boxer
CLASSE E TIPO DI ATTACO	CLASS	-
APPROVAZIONE	HOMOLOGATION	-
VALORE D	D VALUE	15.85 kN

DATA

DATE

CARICO VERTICALE MAX. S	MAX. VERTICAL LOAD S	150 kg
-------------------------	----------------------	---------------

T = Massa complessiva del veicolo in kg
Total vehicle mass in kg

C = Massa rimorchiabile del veicolo in kg
Towable mass of the vehicle in kg

must be less than or equal to the reference **T**

must be less than or equal to the reference **C**

If these conditions are not met, the following calculation must be made:

Se **D** risulta inferiore a **15.85 kN** (valore riportato sulla targhetta e sul presente documento) il dispositivo **può essere installato**
 If **D** is less than **15.85 kN** (value shown on the plate and on this document) **the device can be installed**

USER

2 OPEN

1

A

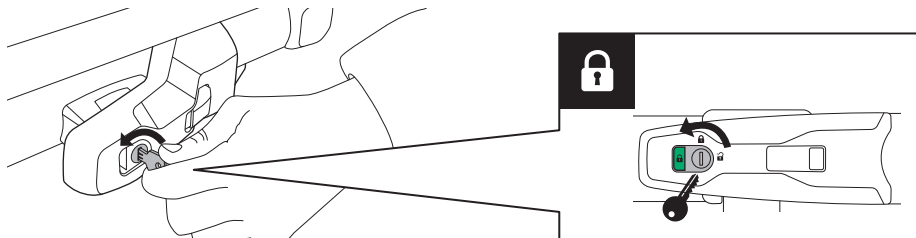

B

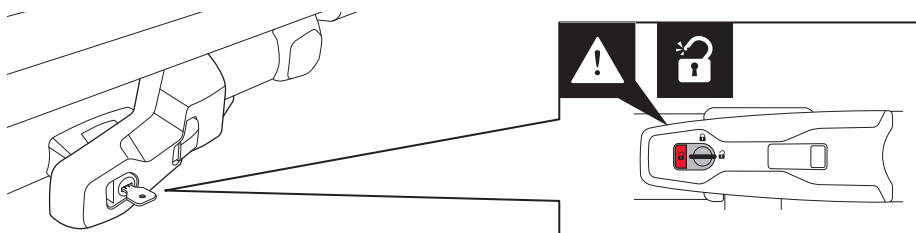

C

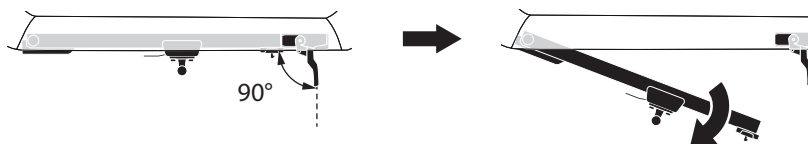
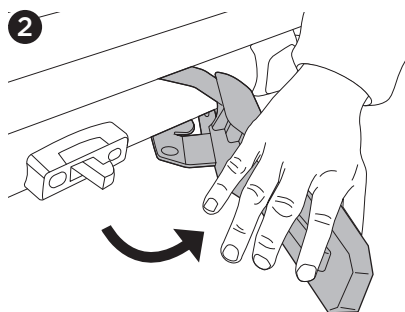
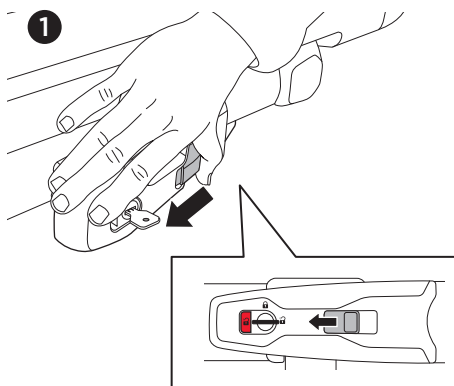

2

A

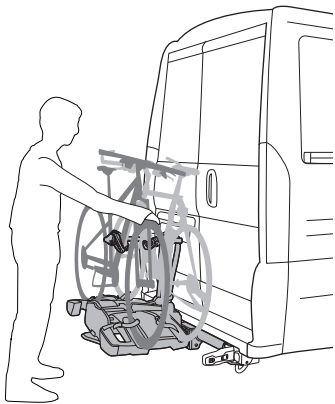

B

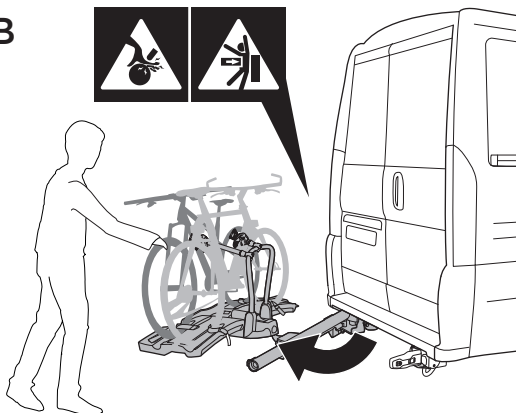

C

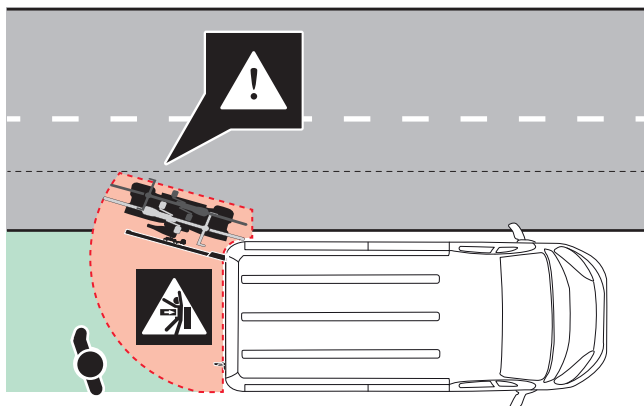
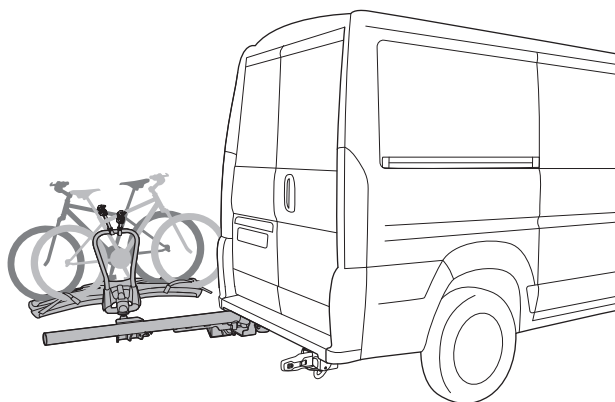

3

A

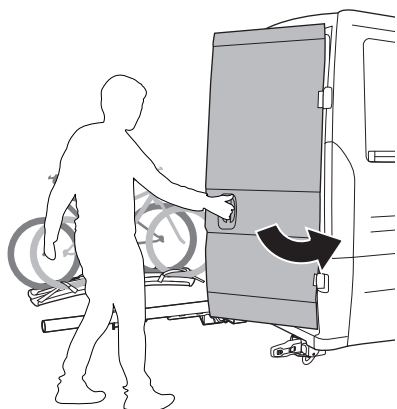

B

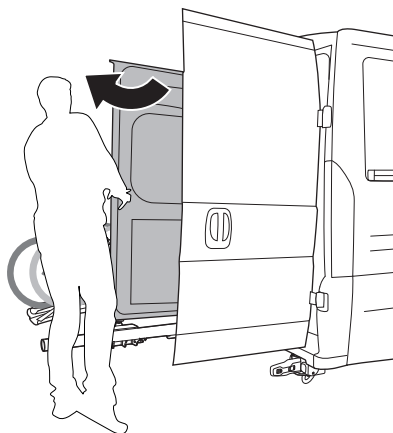

C

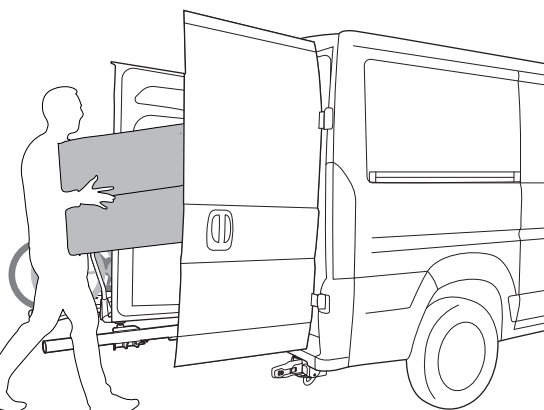

OPTION 1

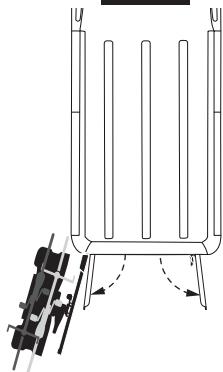

OPTION 2

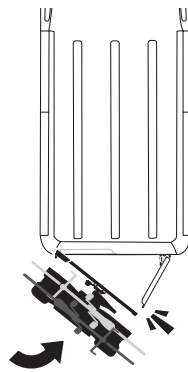
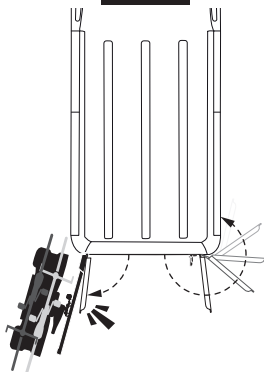

3 CLOSE

1

A

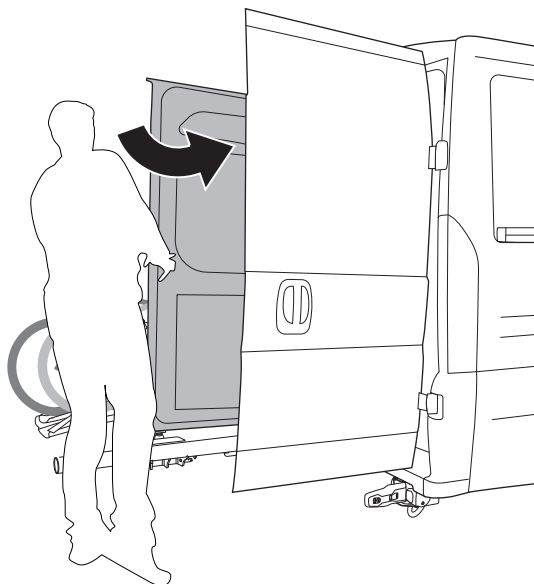

B

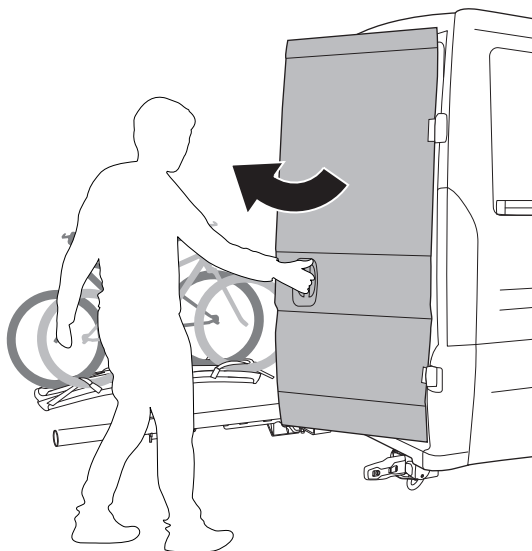

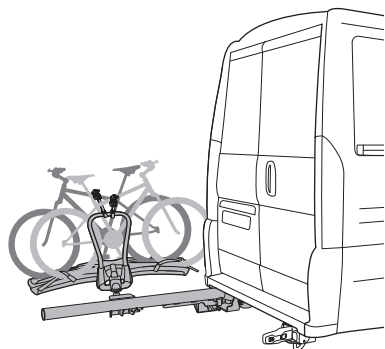
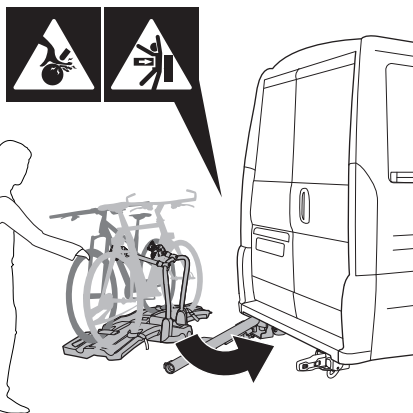
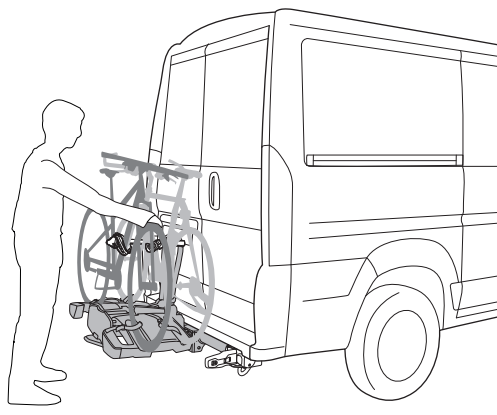
2**A****B****C**

3

A **1**

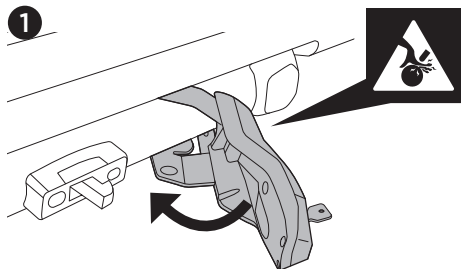

2

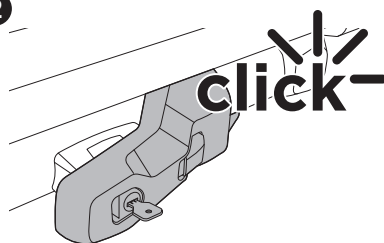

B

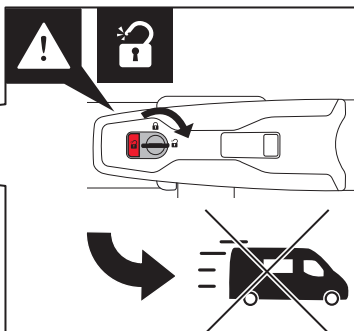
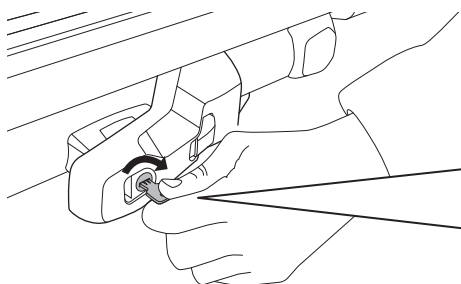

C

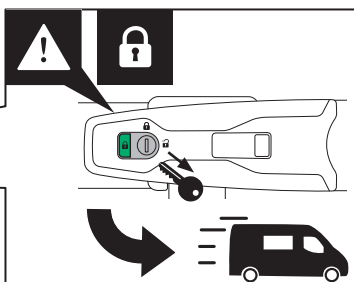
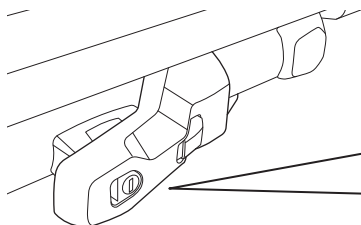

i

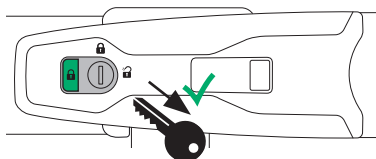
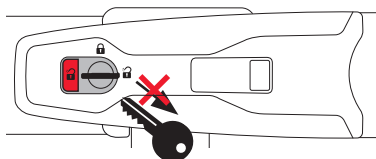



Fiat Ducato IV 2006 - XL (L4, H2-H3)
Citroën Jumper 2006 - XL (L4, H2-H3)
Peugeot Boxer 2006 - XL (L4, H2-H3)

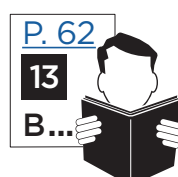
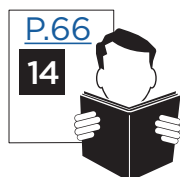
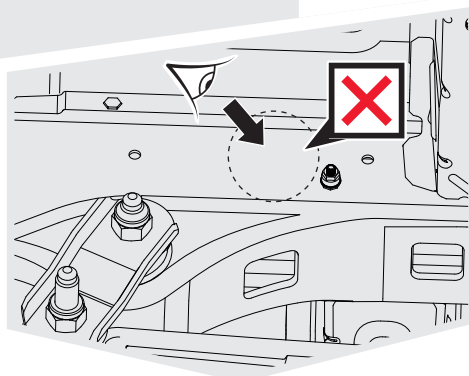
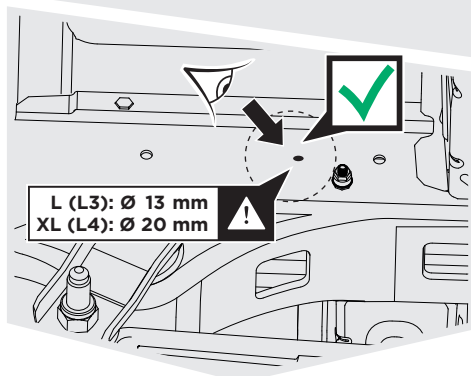
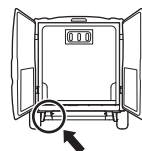

B

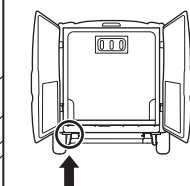
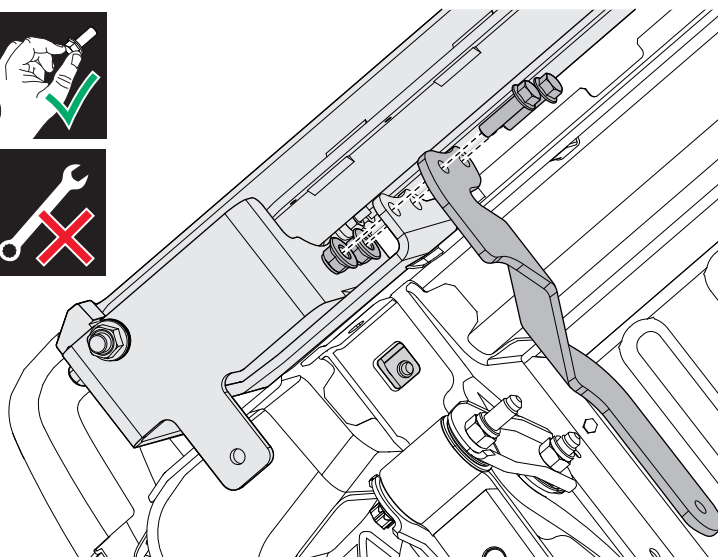

C

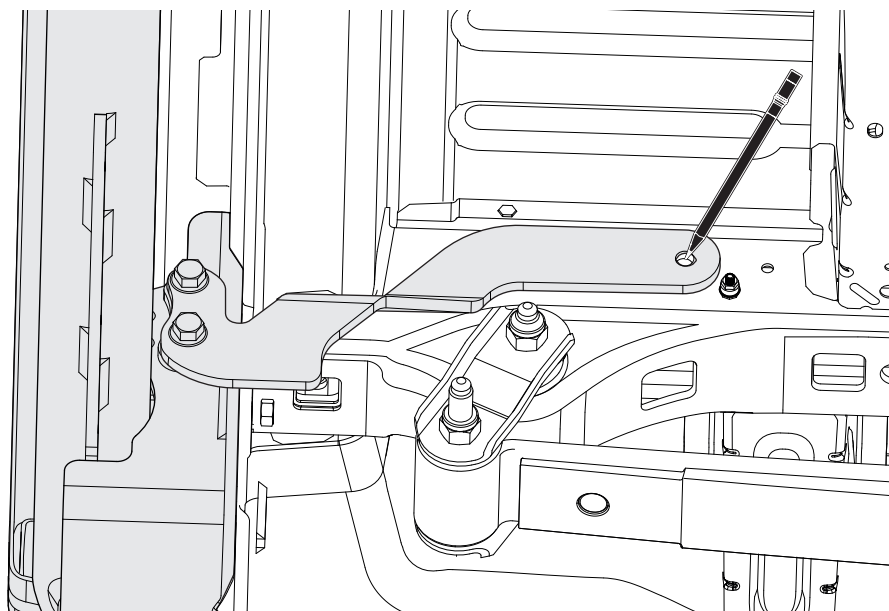
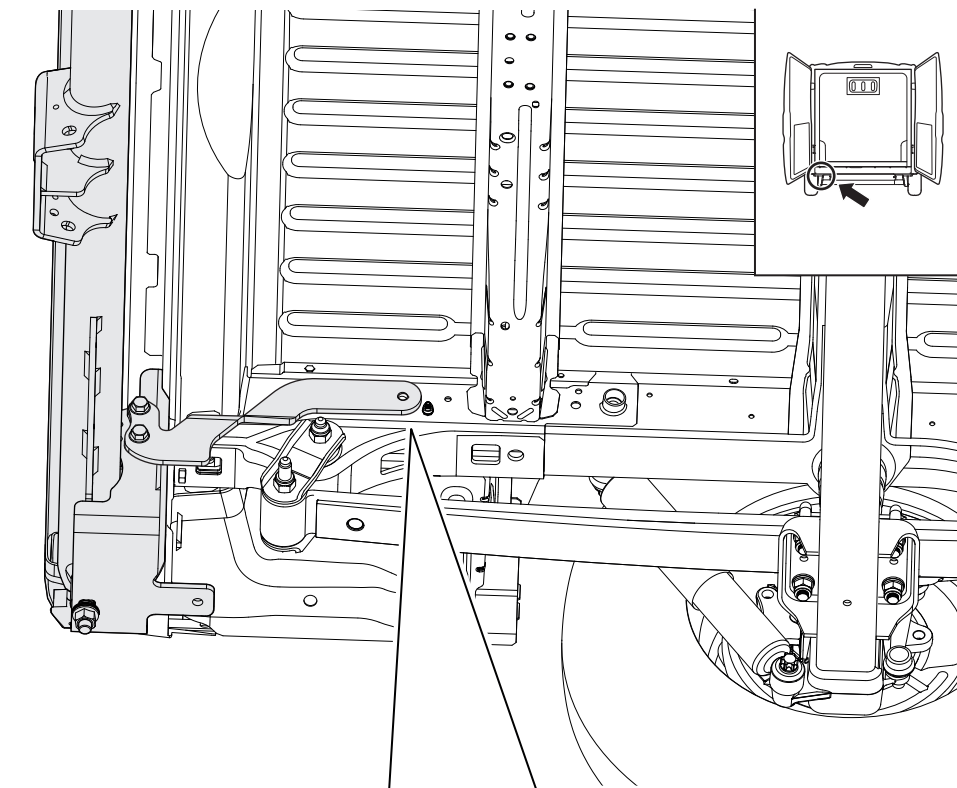

D

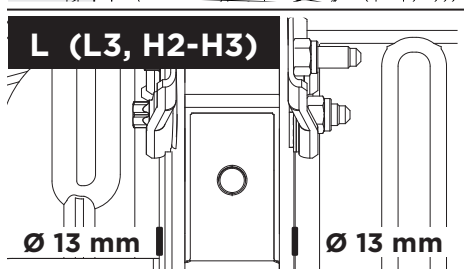
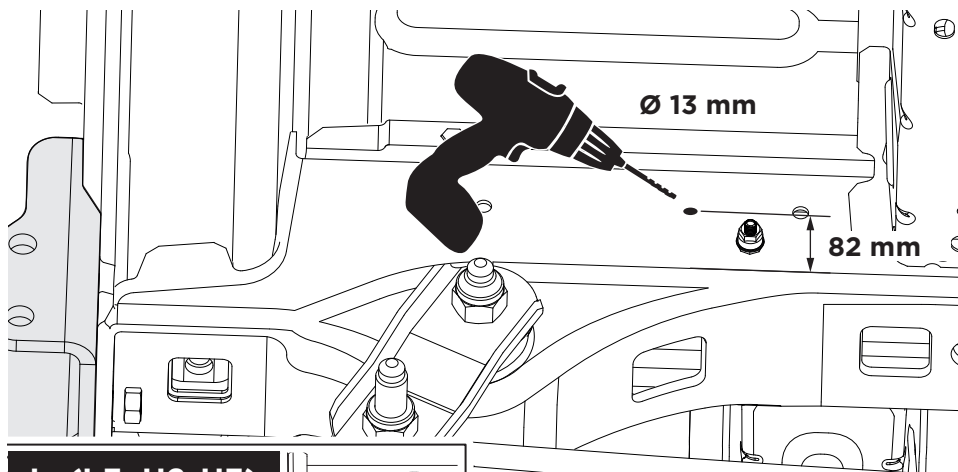
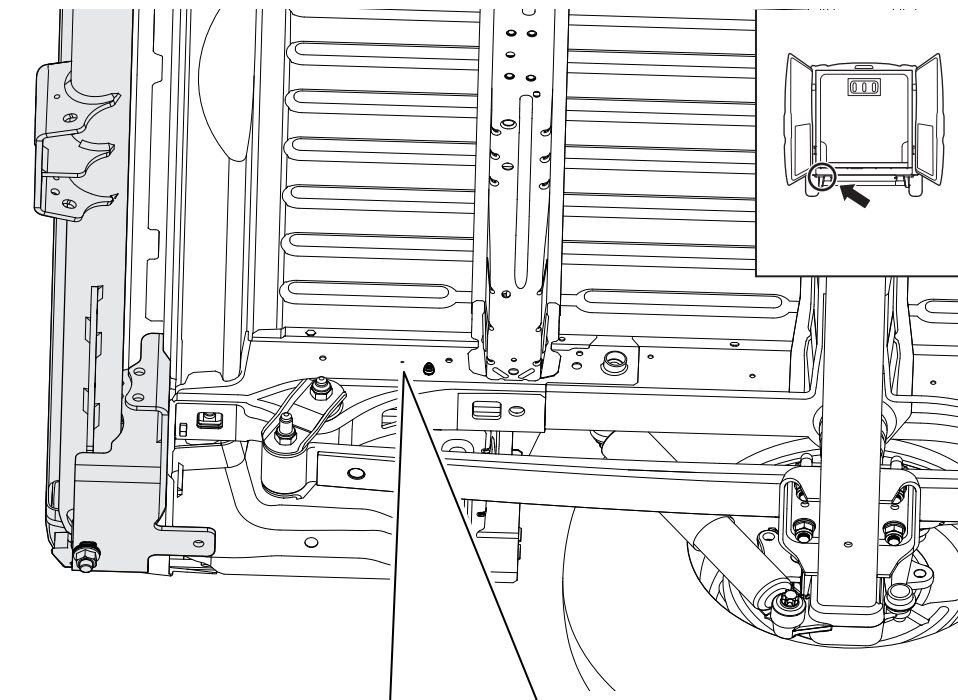

E

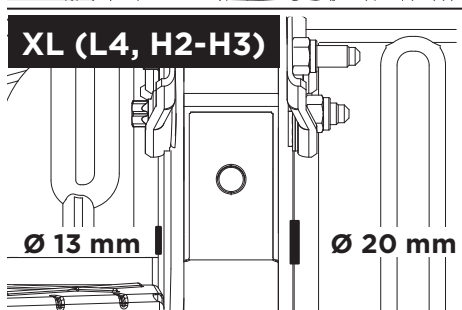
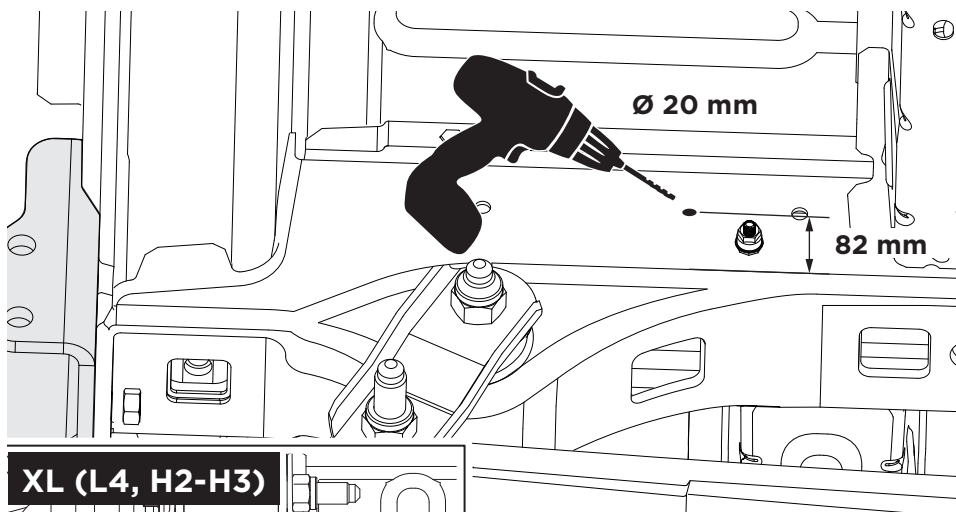
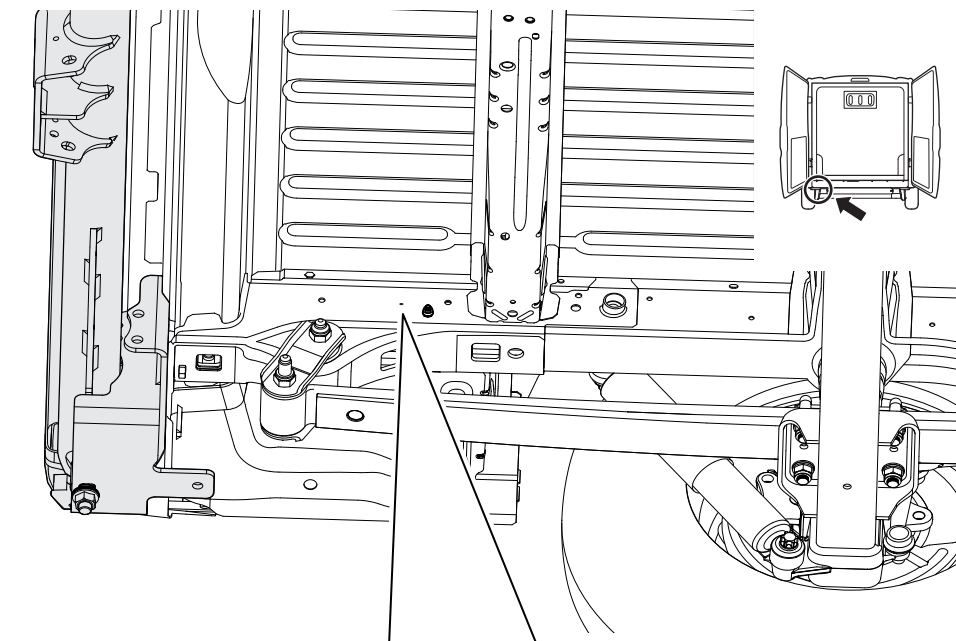

14

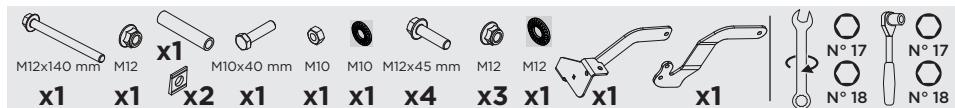

A

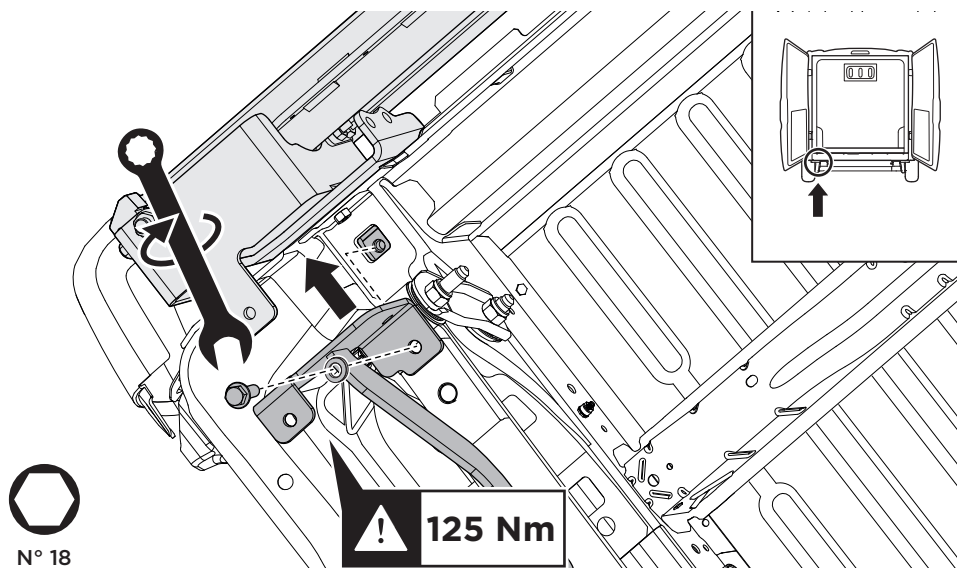

B

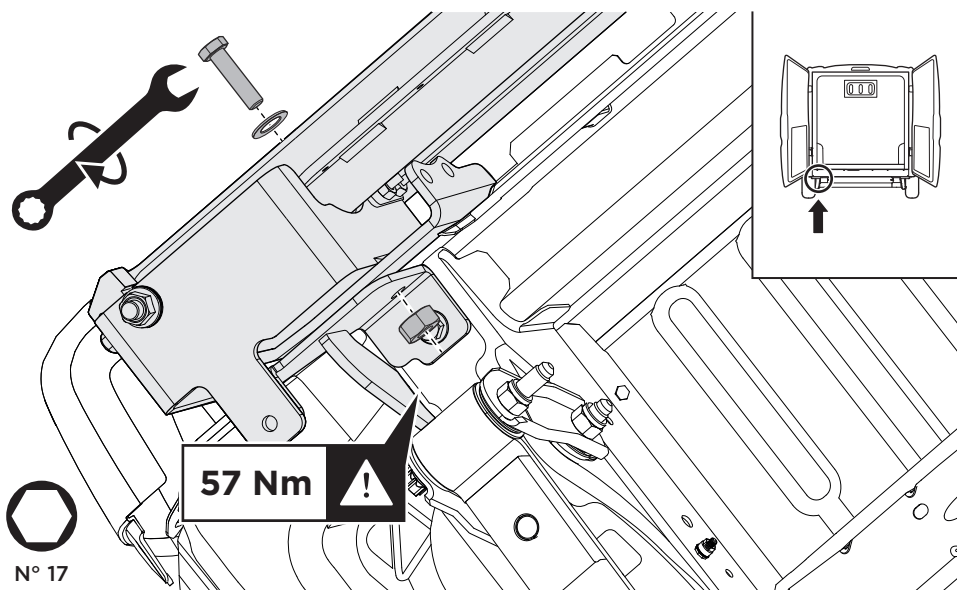

C

